

*S. 4765*  
2

MEMORANDUM.

To *The Chief Surveyor*  
*Auckland*

Surveyor-General's Department,

Wellington, *22 April*, 18*91*

C.S. AUCKLAND  
N<sup>o</sup>.  $\frac{89}{34}$

The Government has directed that whenever a Surveyor is in the neighbourhood a section of 20 acres in extent as near as possible to section 284 parish of Waiotaki should be surveyed for *Mereana Hauauru*.

The land to be of good cultivable quality.

*Harrison*  
for the Surveyor General

It would be best to lay it out along road 175 which already belongs to *M. Hauauru*

*M. Hauauru*  
*Plan register*  
*26-4-91*  
*according to*  
*Wick*

12608  
+154

9  
The 9th 3  
The 9th 3  
The 9th 3

20.0.0  
H  
152

Oahu  
Bay of Plenty  
April 30<sup>th</sup> 1883

To D Percy Smith Esq  
Asst Surveyor General  
Auckland

Sir,

As agent for Meriana Hauawia  
I have the honor to bring before you  
notice the great mistake made  
in summing a 5 acres section surveyed  
for the Arawas, into the 50 acres  
No 125 granted as compensation  
to my client in the year  
1868, and for which a Crown  
grant was issued dated 9<sup>th</sup>  
Nov 1868 I send you a sketch  
taken from Crown grant also  
one taken from the present  
maps

# Waioatake Parish

O.S. AUCKLAND  
 89  
 54

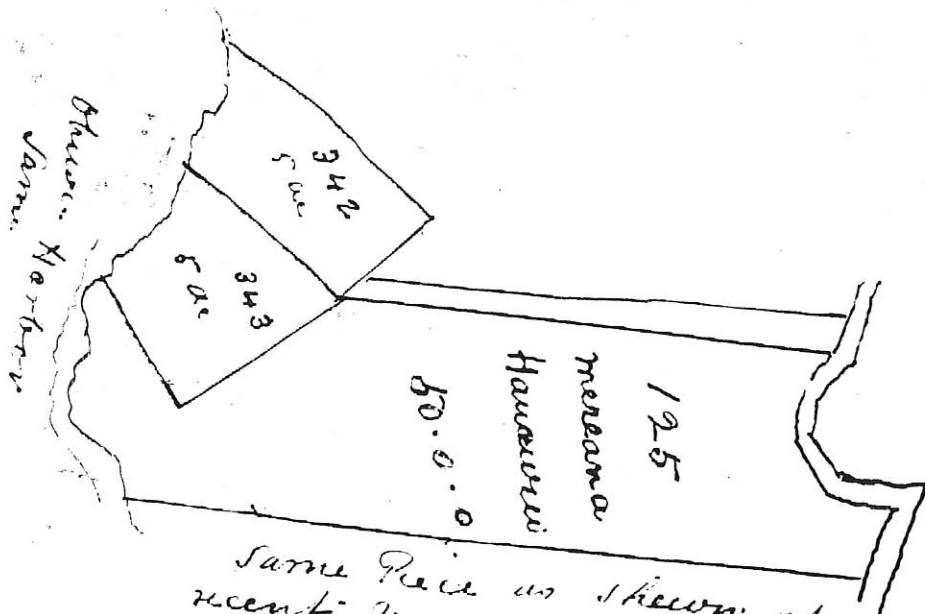

Same Piece as shown upon  
 recent maps with Section  
 No 343 running into it - wrongfully  
 taken by Capt. Keet who surveyed  
 the 5 acre sections for the Crown's

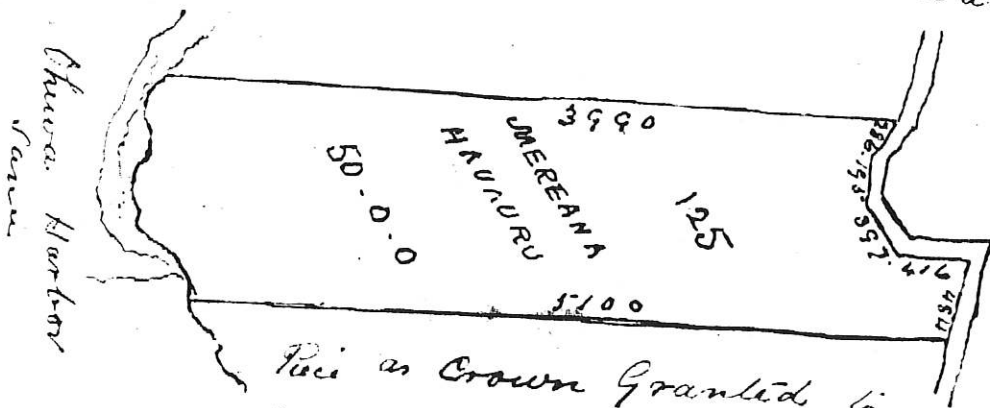

Piece as Crown Granted to  
 Mereana Hawauru  
 9th November 1868

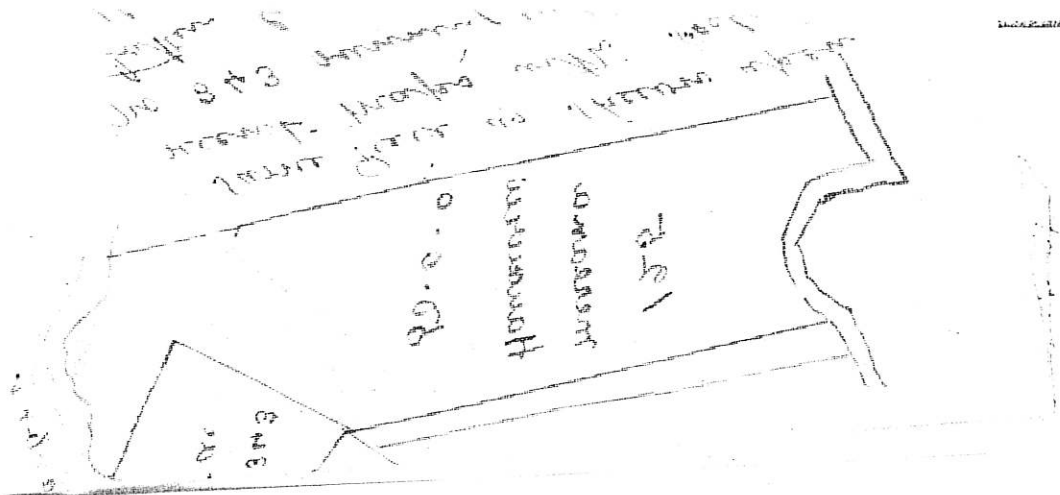

Maps I think you will see  
 at a glance the mistake.  
 trusting that you will  
 kindly see it rectified  
 I have the honor to be  
 with your most  
 Dear Sir  
 J. M. Houston